

ESAO  **2008**

**2nd Announcement
and Call for Papers**

XXXV Annual meeting
European Society for Artificial Organs

**Towards future
biomedical technologies**

Centre Médical Universitaire (CMU)
Geneva – Switzerland
3-6 September 2008

www.esao2008.medecine.unige.ch



Welcome message



On behalf of the European Society for Artificial Organs (ESAO) it is my great pleasure and honour to welcome you to the 35th annual meeting which will be held at the Medical Faculty of the University of Geneva, Switzerland, between 3-6 September, 2008.

Towards future biomedical technologies

will be the theme of this congress which will be organised in collaboration with the Ecole Polytechnique Fédérale de Lausanne (EPFL), the Universities and University Hospitals of Geneva and Lausanne, thus, bringing together all the Science from the Arc Lémanique.

A highly scientific programme has been put together, covering various fields ranging from cardiovascular, liver and kidney support to tissue engineering, cell therapy and transplantation. The ongoing research in these fields, and especially the increased collaborations between various specialties, has led to tangible improvements which benefit the patient. This meeting is not only important as a teaching platform, but also gives young scientists the opportunity to present innovative studies.

Finally, the human networking aspect of such a meeting and exchange of ideas and knowledge are equally important, not only between scientists, but also with our industrial partners whom we thank for their support. We are also indebted to the wide panel of Swiss and international experts who will contribute to making it a 'state-of-the-art' congress.

Geneva is the smallest of the big capitals - host of the world's largest health and humanitarian headquarters - a crossroad of men and ideas - a centre of arts and culture - a melting pot of history - a capital of gastronomy and hospitality, and a starting point for some of the most exciting lake and mountain excursions.

We look forward to welcoming you in Geneva for an interesting and challenging ESAO 2008 annual meeting.

BEAT H. WALPOTH, MD

ESAO and Congress President





Table of contents

	<u>Welcome Message</u>
2	<u>Boards and Committees</u>
5	<u>Scientific Programme Overview</u>
7	<u>Meeting Topics</u>
7	<u>Awards</u>
10	<u>Abstracts</u>
14	<u>Commercial Exhibition & Sponsorship</u>
15	<u>General Information</u>
18	<u>Registration Information</u>
21	<u>Hotel information</u>
23	<u>Social Events & Excursions</u>
	<u>Important Dates</u>

Photos: © Office du Tourisme Genève

www.esao2008.medecine.unige.ch



Boards and Committees

CONGRESS PRESIDENT

Beat H. Walpoth – Geneva

ORGANISING COMMITTEE

At time of printing (February 2008) - Alphabetical

UNIVERSITY OF GENEVA

J-L. Carpentier
R. Gurny
D. Hochstrasser
J. Philippe
P. Spierer

UNIVERSITY HOSPITAL OF GENEVA

P. Dayer
P. Hoffmeyer
A. Kalangos
P-Y. Martin
Ph. Morel

EPFL

P. Aebischer
Y. Barrandon
J. Hubbell
N. Stergiopoulos
M. Swartz

UNIVERSITY AND UNIVERSITY HOSPITAL OF LAUSANNE

M. Burnier
N. Demartine
P. Francioli
P. Frey
L. von Segesser

LOCAL ORGANISING COMMITTEE

T. Berney	S. Karaca
L. Buhler	J. Menetrey
M. Cikirikcioglu	M. Moeller
M. Jaconi	D. Mugnai
E. Khabiri	P. Saudan

ESAO BOARD

<i>President</i>	B.H. Walpoth, Geneva (SUI)
<i>President Elect</i>	B. Meyns, Leuven (BEL)
<i>Past President</i>	G. Rakhorst, Groningen (NLD)
<i>General Secretary</i>	H. Schima, Vienna (AUT)
<i>Treasurer</i>	J.M. Wojcicki, Warsaw (POL)
<i>Honorary President</i>	H. Klinkmann, Rostock (GER)
<i>Honorary Members</i>	V. Bonomini, S. Stefoni, Bologna (ITA)



ESAO GOVERNORS

A. Bader, Leipzig (GER)

A. Buscaroli, Bologna (ITA)

B. Glasmacher, Hannover (GER)

U.R. Kertzsch, Berlin (GER)

P. Ladyzynski, Warsaw (POL)

C. Legallais, Compiègne (FRA)

R.L. Reis, Braga (POR)

I. Sauer, Berlin (GER)

A. Sikole, Skopje (MKD)

P. Verdonck, Ghent (BEL)

G. Wieselthaler, Vienna (AUT)

Coopted Board Members: I. Ledebø, Lund (SWE) • J. Vienken, Bad Homburg (GER)

ESAO WORKING GROUP LEADERS

Uremic Toxins

R. Vanholder, Ghent (BEL)

Liver

I. Sauer, Berlin (GER)

Heart

J. Canizo, Madrid (ESP)

Apheresis

B. Stegmayr, Umea (SWE)

Tissue Engineering

R.L. Reis, Braga (POR)

Education

D. Falkenhagen, Krems (AUT)



INTERNATIONAL SCIENTIFIC ADVISORY BOARD

At time of printing (February 2008) - Alphabetical

K. Affeld (GER)
S. Ash (USA)
A. Bader (GER)
A. Baertschi (SUI)
R. Bartlett (USA)
U. Baumeister (GER)
D. Belin (SUI)
J.O. Bonatti (AUT)
V. Bonomini (ITA)
G.L. Bowlin (USA)
A. Buscaroli (ITA)
D. Candinas (SUI)
T. Carrel (SUI)
J.L. Chachques (FRA)
P.A. Clavien (SUI)
P. Corris (GBR)
N. de Jonge (NLD)
J.F. del Canizo (ESP)
M. Deutsch (AUT)
G. Dunea (USA)
G. Faggian (ITA)
D. Falkenhagen (AUT)
J. Feyen (NLD)
M. Furrer (SUI)
M. Genoni (SUI)
F. Geroulanos (GRE)
B. Glasmacher (GER)
A. Haverich (GER)
M. Heberer (SUI)
O.M. Hess (SUI)
R. Hetzer (GER)
S.P. Hoerstrup (SUI)
W.L. Holman (USA)

D. Humes (USA)
K. Imachi (JPN)
P. Ivanovich (USA)
M. Jaffrin (FRA)
U.R. Kertzscher (GER)
C.J. Kirkpatrick (GER)
H. Klinkmann (GER)
D. Kong (CHN)
I. Krejci (SUI)
S. Küçükaksu (TUR)
P. Ladyzynski (POL)
G. Laufer (AUT)
I. Ledebø (SWE)
C. Legallais (FRA)
A. Leirner (BRA)
B. Lindholm (SWE)
D.Y. Loisançe (FRA)
J.W. Long (USA)
U. Losert (AUT)
M. Lysaght (USA)
F. Mach (SUI)
H. Mann (GER)
A. Mazzucco (ITA)
B. Meyns (BEL)
K. Mottaghy (GER)
T. Nakatani (JPN)
Y. Nose (USA)
R. Ploeg (NLD)
B.K. Podesser (AUT)
M. Polenakovic (MKD)
J.L. Pomar (ESP)
P. Portner (USA)
G. Rakhorst (NLD)

W. Ramlow (GER)
B. Reichart (GER)
H. Reichenspurner (GER)
R.L. Reis (POR)
B. Reitz (USA)
W.E. Richenbacher (USA)
C. Ronco (ITA)
I. Sauer (GER)
P.T. Sergeant (BEL)
H. Schima (AUT)
S. Schueler (GBR)
W. Schütt (AUT)
A. Sikole (MKD)
S. Stefoni (ITA)
D.A. Steinbrüchel (DEN)
G. Steinhoff (GER)
B. Stegmayr (SWE)
K. Sun (KOR)
Y. Taenaka (JPN)
S. Takatani (JPN)
H. Tevæarai (SUI)
A. Undar (USA)
R. Vanholder (BEL)
P. Verdonck (BEL)
J. Vienken (GER)
G. von Sengbusch (GER)
V. Weber (AUT)
A. Werynski (POL)
G.M. Wieselthaler (AUT)
J.M. Wojcicki (POL)
E. Wolner (AUT)
P. Zilla (RSA)
A. Zisch (SUI)
G. Zuend (SUI)

ESAO INFORMATION

General Secretary:

Prof. H. Schima

Vienna (AUT)

E-mail: heinrich.schima@meduniwien.at

For membership application please consult the ESAO web-page: www.esao.org

The ESAO General Assembly will be held on Friday, 5 September in the afternoon following the scientific sessions.



Scientific Programme Overview

SESSIONS

The Scientific Programme will include several types of sessions, all related to the Congress main topics:

- Opening Session
- Keynote Lectures (Plenary Sessions)
- Invited Lectures
- Free Communications
- ESAO Corporate Symposium (Plenary Session)
- Symposia from Affiliated Societies
- Supported Lunch Symposia
- Moderated Poster Presentations
- Postgraduate Courses
- Working Group Sessions
- Closing Session

OPENING SESSION (WEDNESDAY, 3 SEPTEMBER – 17:00-19:00)

Official welcome by the authorities, rectors and deans.

Highlights from the three co-organising universities: EPFL, Geneva and Lausanne.

KEYNOTE LECTURES (PLENARY SESSIONS)

Thursday, Friday and Saturday: 08:30-09:30.

The plenary sessions will be devoted to three speakers addressing the state-of-the-art of support, regeneration and transplantation for heart, kidney and liver.

INVITED LECTURES

Each session will be introduced by an invited speaker, specialised on the topic of the session.

FREE COMMUNICATIONS

There will be over 100 oral communications, divided in topic-related sessions, selected from the best submitted abstracts.

ESAO CORPORATE MEMBERS SYMPOSIUM (PLENARY SESSION)

Thursday, 4 September: 11:00-12:00.

“Therapy Development to Meet Future Patient Requirements”

SYMPOSIA FROM AFFILIATED SOCIETIES

American Society for Artificial Organs (ASAIO)
European Society for Organ Transplantation (ESOT)
International Faculty for Artificial Organs (INFA)
World Apheresis Association (WAA)

SUPPORTED LUNCH SYMPOSIA

Six industry-supported lunch symposia will be organised on Thursday and Friday.

MODERATED POSTER PRESENTATIONS

Posters will be discussed during the Moderated Poster Sessions on Thursday and Friday afternoons. The posters will be on display during the whole duration of the congress. Details on poster format and presentation will be given together with the acceptance letter. There will be a maximum of 200 posters.

POSTGRADUATE COURSES

On Wednesday afternoon 3 September, several postgraduate courses will be organised by the ESAO together with respective Swiss Societies working in the field of gastroenterology/hepatology, nephrology, orthopaedics, thoracic and cardiovascular surgery and transplantation.

WORKING GROUP SESSIONS

During the ESAO congress, the ESAO Working Groups will organise their special sessions on the following topics:

Apheresis, Heart, Liver, Tissue Engineering, Uremic Toxins.

Traditionally the ESAO Liver Working Group holds a symposium entitled "1-day on the liver".

CLOSING SESSION

The ESAO Wichtig Award will be handed out during the Closing Session and the author will present his study.

INVITED SPEAKERS

Confirmed at time of printing (February 2008) - Alphabetical

Y. Barrandon (SUI)	A. Kalangos (SUI)
G.L. Bowlin (USA)	D.Y. Loisançe (FRA)
G. Faggian (ITA)	M. Lysaght (USA)
A. Haverich (GER)	Ph. Morel (SUI)
J.A. Hubbell (SUI)	R. Ploeg (NLD)



Meeting Topics

Apheresis	Bone, Joint, Dental	Medical Implants
Artificial Blood	Prostheses	Nano Medicine
Artificial Cells	Cardiopulmonary Bypass	Neuroprostheses
Artificial Heart	Cell & Gene Therapy	Organ Preservation
Artificial Kidney	Circulatory Assistance	Peritoneal Dialysis
Artificial Liver	Computer Modelling	Polymers & Scaffolds
Artificial Lung	Drug Delivery Systems	Regenerative Medicine
Artificial Pancreas	Electrostimulation	Robotics
Artificial Skin	Fluid Dynamics	Sensory Aids
Artificial Valves	Gas Exchange / ECMO	SIRS & Artificial Organs
Biocompatibility	Genomics & Proteomics	Stents
Bioengineering	Hemodialysis	Surface Modifications
Biomaterials	Hemoperfusion	Tissue Engineering
Bioreactors	Hybrid Artificial Organs	Transplantation
Biosensors	Medical Device	Urological Prostheses
Blood Purification	Medical Engineering	Vascular Prostheses

Awards

ESAO WICHTIG AWARD

The Annual ESAO Wichtig Award of 2500 Euro is the most prominent award of the ESAO. It is aimed at encouraging young scientists (younger than 38 years) working in the field of artificial organ research. This award is based on the best peer-reviewed publication which will be briefly presented following the Award ceremony that will take place during the closing session. A call for submission will be available on the ESAO web-site and in the International Journal for Artificial Organs. The ESAO would like to thank Wichtig Editore for sponsoring this award.

ESAO POSTER AWARDS

Three Poster Awards (500, 300 and 200 Euro) will be given to the authors of the best posters, based on scientific content and presentation, selected by a special committee. Awards will be presented during the Congress Dinner (Friday, 5 September 2008).

ESAO INNOVATION AWARD

An Award of 500 Euro will be dedicated to the most innovative abstract presented. The selection will be made by a jury, based on abstract content and presentation. The award will be presented during the Congress Dinner (Friday, 5 September 2008).



Preliminary Congress Schedule

as of February 2008

	Wednesday 3 September	Thursday 4 September	Friday 5 September	Saturday 6 September
	10:00-20:00 Registration Open	08:00-18:00 Registration Open	08:00-18:00 Registration Open	08:00-14:00 Registration Open
08:00-08:30	08:00-13:00 Exhibition Build-Up	09:00-17:30 Exhibition Open	09:00-17:30 Exhibition Open	09:00-14:00 Exhibition Open
08:30-09:00		Plenary Session	Plenary Session	Plenary Session
09:30-09:30				
09:30-10:00		Poster Viewing & Exhibition and Coffee Break	Poster Viewing & Exhibition and Coffee Break	Scientific Sessions (3x)
10:00-10:30		Symposia of affiliated societies	Symposia of affiliated societies	
10:30-11:00				
11:00-11:30		Corporate Members Symposium	Working Group Sessions	Poster Viewing & Exhibition and Coffee Break
11:30-12:00				Scientific Sessions (3x)
12:00-13:00		Supported Lunch Symposia	Supported Lunch Symposia	
13:00-13:30				Closing Ceremony
13:30-14:00	Post-Graduate Courses Part I	Scientific Sessions (3x)	Scientific Sessions (3x)	Farewell Drink
14:00-14:30				14:00-17:00 Exhibition dismantling
14:30-15:00				
15:00-15:30	Coffee Break	Moderated Poster Session Exhibition and Coffee Break	Moderated Poster Session Exhibition and Coffee Break	
15:30-16:00	Post-Graduate Courses Part II			
16:00-16:30		Scientific Sessions (3x)	Scientific Sessions (3x)	
16:30-17:00				
17:00-17:30	Exhibition Open			
17:30-18:00	Opening Ceremony		ESAO General Assembly	
18:00-18:30				
18:30-19:00				
19:00-19:30	Welcome Reception	Concert	Congress Dinner	
19:30-20:00				

Preliminary Programme

WEDNESDAY 3 SEPTEMBER 2008

- 13:30 - 15:00 Postgraduate Courses - Part I (parallel sessions)
15:00 - 15:30 *Coffee Break*
15:30 - 17:00 Postgraduate Courses - Part II (parallel sessions)
17:00 - 19:00 Opening Ceremony (plenary Session)
19:00 - 20:00 *Welcome Reception*

THURSDAY 4 SEPTEMBER 2008

- 08:30 - 09:30 Plenary Session
09:30 - 10:00 Poster viewing & Exhibition
and Coffee Break
10:00 - 11:00 Symposia of affiliated societies (parallel sessions)
11:00 - 12:00 Corporate Members Symposium (plenary session)
12:00 - 13:30 Supported Lunch Symposia (parallel sessions)
13:30 - 15:00 Scientific Sessions (parallel sessions)
15:00 - 16:00 Moderated Poster Sessions 1, Exhibition
and Coffee Break
16:00 - 17:30 Scientific Sessions (parallel sessions)
19:00 - 20:00 *Concert*

FRIDAY 5 SEPTEMBER 2008

- 08:30 - 09:30 Plenary Session
09:30 - 10:00 Poster viewing & Exhibition
and Coffee Break
10:00 - 11:00 Symposia of affiliated societies (parallel sessions)
11:00 - 12:00 Working Group sessions (parallel sessions)
12:00 - 13:30 Supported Lunch Symposia (parallel sessions)
13:30 - 15:00 Scientific Sessions (parallel sessions)
15:00 - 16:00 Moderated Poster Sessions 2, Exhibition
and Coffee Break
16:00 - 17:30 Scientific Sessions (parallel sessions)
17:30 - 18:00 ESAO General Assembly
19:00 - 23:00 *Congress Dinner*

SATURDAY 6 SEPTEMBER 2008

- 08:30 - 09:30 Plenary Session
09:30 - 11:00 Scientific Sessions (parallel sessions)
11:00 - 11:30 Exhibition
and Coffee Break
11:30 - 13:00 Scientific Sessions (parallel sessions)
13:00 - 13:30 Closing Ceremony
13:30 - 14:00 *Farewell Drink*



Abstracts

MAIN TOPICS FOR ABSTRACT SUBMISSION

- Bio-artificial heart and cardiac assist devices (+CPB)
- Bio-artificial kidney and dialysis
- Bio-artificial liver and assist devices
- Bio-artificial lung and gas exchange (+ECMO)
- Bio-artificial pancreas & related technologies
- Bio-artificial skin, bone, joints, teeth
- Bio-materials / bio-engineering / hybrid organs
- Cardiovascular implants
- Computer modelling / fluid dynamics / electro-stimulation
- Hemapheresis and blood substitutes
- Regenerative medicine (cell therapy / tissue engineering)
- Robotics / simulation
- Sensory bio-organs and neuro-prostheses
- Transplantation / bridging / immunosuppression
- Other medical implants / drug delivery / miscellaneous

For more detailed topics of the meeting, see page 7.

GUIDELINES

Please read this information carefully before proceeding to the online submission form

IMPORTANT DATES

Submissions accepted from: 15 February 2008

Submission deadline: 01 April 2008, Midnight CET

Notifications to submitters: 15 May 2008

Abstracts received after the deadline will not be accepted!

TECHNICAL REQUIREMENTS

The internet abstract submission system works best with Mozilla Firefox:

- Cookies needs to be enabled
- All pop-up blockers should be turned off

GENERAL

Abstracts can only be submitted online via the online abstract submission form that can be found in the section "abstracts" on the official ESAO 2008 Meeting website:

www.esao2008.medecine.unige.ch

Abstracts sent by post or email will not be accepted. No exceptions will be made.



DEFINITIONS

<i>Submitting author:</i>	person who physically submits the abstract
<i>Presenting author:</i>	person who will physically present the abstract at the congress and who is marked as the presenter in the program
<i>First author:</i>	First author cited who scientifically endorses the abstract and is therefore responsible for its content

RULES

Failure to observe these guidelines may result in disqualification.

1. Go to **www.esao2008.medecine.unige.ch** on the Internet. Click on "ABSTRACTS" and follow instructions as given.
2. An abstract can be submitted to the ESAO 2008 Meeting if it has not been published previously and only presented at a national meeting.
3. The correct topic must be selected to ensure correct scoring. The content of the abstract must be topic related.
4. Abstracts must contain data and meet international ethical standards.
5. Abbreviations should be defined.
6. Trade names cannot be mentioned in the title. However, trade names in brackets will be accepted in the body of the text.
7. An abstract cannot be accepted if the conflict of interest disclosure has not been ticked on the submission form. If the research or one of the co-authors has a conflict of interest, this must be clearly stated (Industry support / Shareholder, etc.).
8. The abstract cannot contain more than 2300 characters (blank spaces, punctuation as well as authors' affiliation and titles included).
9. The abstract must be structured into the following sections:
 - a. Objectives
 - b. Methods
 - c. Results
 - d. Conclusions
10. One table can be included, but the total number of cells (columns+rows) may not exceed 12. Please note that tables may significantly reduce the number of available characters.
11. If you have successfully submitted your abstract, you will receive a confirmation number. If no confirmation number is received, the abstract cannot be considered as successfully submitted and accepted by the system.



- 12 Submitted abstracts can be re-edited and modified until the submission deadline (**01 April 2008, Midnight CET**). Therefore, the author submitting the abstract will be required to provide his/her e-mail address as the login and a preferred password during the submission. To save the abstract, all required fields (marked with a red *) must be filled in. If you leave the system without having provisionally submitted the abstract, all data is lost. The submitted abstracts cannot be edited after the submission deadline (**01 April 2008, Midnight CET**).
13. Please ensure that your abstract does not contain spelling, grammatical or scientific errors. No corrections are possible after the submission deadline. The abstract will be **reproduced exactly as submitted**. No proofreading will be done.
14. If you need to withdraw your abstract, a written statement reflecting the reasons for this decision must be sent to: ESAO2008@mci-group.com, no later than **31 April 2008**.
15. A number of awards will be given for the best abstracts presented as oral or poster presentations. Please refer to page 7.

AFTER THE SUBMISSION

1. The reviewers will judge the abstracts according to the relevance of the topic of the ESAO 2008 meeting, standard of English, objectivity of statements, description of what was done, suitability of methods to aims, conclusions confirmed by objective results, ethics, scientific value, potential clinical value, originality of work and overall impression.
2. The submitting authors will be notified by **15 May 2008**, at the email address provided during submission, whether their abstract has been accepted. It is the author's responsibility to ensure that emails from ESAO can reach them. They will be informed at the same time about the date, time and form of their presentation.

PUBLICATION POLICY

All abstracts accepted for presentation (oral or poster) will be published in a regular issue of the International Journal of Artificial Organs, official journal of the ESAO. Authors (lectures, Symposia, Free Communications and Posters) are encouraged to submit the complete manuscript of their presentation to the International Journal of Artificial Organs. A publication desk from Wichtig Editore will be located in the exhibition area.

PRESENTATION OF ABSTRACTS

1. Abstracts can be accepted either as poster, or oral communication.
2. If your abstract is accepted as a poster, you will be requested to be available for discussion during the corresponding moderated poster viewing session.



3. Details on poster format will follow with the acceptance letter. Pins and adhesive material will be provided.
4. Please use letters large enough to be read from a distance of 1.5 meters (4.9 feet).
5. Oral presentations will be allocated 10 minutes each plus 5 minutes discussion time. Facilities to convert slides to data will be available at the Congress, if required. PowerPoint data projection with single screens will be available in all session rooms. A slide centre will be available and each presenter is required to hand in his presentation minimum 2 hours before his session. No personal computers will be allowed. Files must be prepared on Powerpoint 2000/2003 format on a CD-Rom or USB stick.
6. Full presentation guidelines will be included in the acceptance letter and posted on the congress website

PROBLEMS SUBMITTING?

If you experience any kind of problem or if you have questions, please do not hesitate to contact:

Lara Poethig

Phone: +41 22 33 99 629

Fax: +41 22 33 99 601

Email: ESAO2008@mci-group.com



FLOOR PLAN

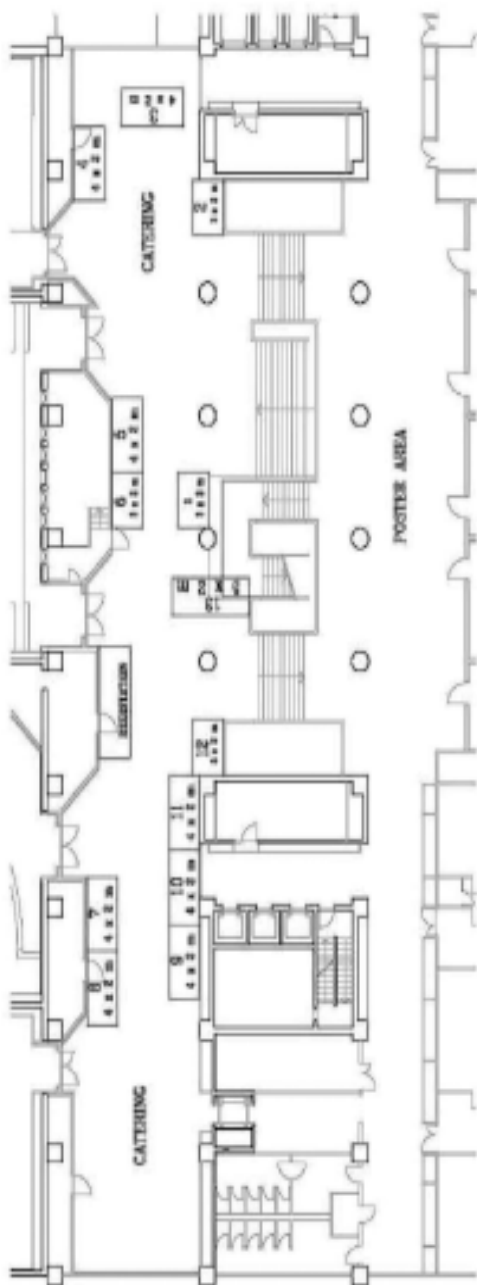

Commercial Exhibition & Sponsorship

During the meeting, ESAO presents an attractive exhibition to all participants and accompanying persons. All coffee breaks and catering will be served in the exhibition area. Poster sessions will be located near the exhibition area; participants will have to walk through the exhibition to access this point.

For further information on Exhibition
& Sponsorship opportunities,
please contact:
MCI Suisse SA
Christopher Day
Tel: +41 (0) 22 33 99 650
christopher.day@mci-group.com

The Sales Manual is available on the
ESAO meeting website
www.esao2008.medicine.unige.ch

EXHIBITION OPENING HOURS

Wednesday, 3 September 2008

14:30 - 20:00
(Welcome Reception)

Thursday, 4 September 2008

09:00 - 17:30

Friday, 5 September 2008

09:00 - 17:30

Saturday, 6 September 2008

09:00 - 14:00



General Information

ABOUT GENEVA

Geneva has been successful in combining the best of both worlds. It is an up-to-date international centre of world importance and a small and friendly town of only 180,000 inhabitants. Set on the banks of Lake Léman between the Alps and the Jura mountains in the Southwest corner of Switzerland, Geneva enjoys a temperate climate and breathtaking scenery, with Alpine lakes, snow-capped mountains, lush forests and enchanting countryside. Many international organisations have their headquarters here, the most famous being the United Nations. The city has over 30 museums, as well as many art galleries, theatres and an opera house where an impressive number of famous artistes have appeared. Fashionable hotels, chic restaurants and elegant shops jostle for position along the flower-decked lakefront which encircles the famous "jet d'eau" fountain signalling the coming of spring each year. It spouts 140 metres over Lake Geneva shooting 500 litres of water per second.

Several local restaurants have been awarded top marks in the Michelin guide and a wide variety of cuisine is available to suit all tastes. Sports enthusiasts will find that Geneva has much to offer and golfers in particular will not want to miss the opportunity to visit at least one of the 26 golf clubs in the region.

HOW TO COME TO GENEVA

Located in the centre of Europe, Geneva is easily accessible by air and train from all major European cities, and there are interesting low-budget connections from several of them. The international airport is only 15 minutes from downtown.

CERTIFICATE OF ATTENDANCE

A certificate of attendance will be included in the congress bag. It can be used by the participant to claim CME points in his/her own country.

CME

The ESAO Congress 2008 has CME approval for the official scientific programme. Exact number of points will be confirmed on-site on the Certificate of Participation. Satellite Symposia are not CME approved unless the organisers have gained approval for the symposiums from the UEMS.

CONGRESS DATE

The meeting will start on Wednesday, 3 September 2008 and will end on Saturday, 6 September 2008.

CONGRESS DOCUMENTS AND BADGES

Congress documents should be collected on-site at the registration desk at the CMU. Name badges must be worn visibly all times during the congress and in the exhibition area.

CONGRESS ORGANISER

MCI has been selected by ESAO as the official Congress Organiser to process registrations, abstract handling, exhibition and sponsorship. All correspondence should be sent to:

ESAO 2008

c/o MCI SUISSE SA

Rue de Lyon 75

CH-1211 Geneva 13

Switzerland

Tel + 41 22 33 99 571

Fax + 41 22 33 99 601

E-mail: esao2008@mci-group.com

Website: www.mci-group.com

CONGRESS VENUE AND LOCATION

The XXXV Annual meeting of the European Society of Artificial Organs will be held at the **Centre Médical Universitaire (CMU), Rue Michel-Servet 1, 1206 Geneva.**

The CMU is located next to the University Hospital not far away from the city centre.

How to get there:

Buses 1, 5 and 7 stop Hôpital

Bus 3 stop Claparède

REGISTRATION DESK OPENING HOURS

Wednesday	3 September 2008	10:00 - 20:00
Thursday	4 September 2008	08:00 - 18:00
Friday	5 September 2008	08:00 - 18:00
Saturday	6 September 2008	08:00 - 14:00

GETTING AROUND IN GENEVA

A complimentary transportation ticket, offered by Geneva International Airport and valid 80 minutes on the entire "Unireso Genève", may be obtained in the baggage claim area. Associated to the "Geneva Transport Card", offered upon check-in in the hotels, you may use the entire public transportation network without restriction (bus, train and boat), with validity for the entire duration of your stay.



OFFICIAL LANGUAGE

The official meeting language is English. No simultaneous translation will be provided.

SCIENTIFIC SECRETARIAT

Beat H. Walpoth, MD, PD, FAHA
Director of Cardiovascular Research
President, European Society for Artificial Organs
Department of Surgery
University Hospital
CH-1211 GENEVA 14, Switzerland
Tel. +41 22 37 27 631 / 40
Fax +41 22 37 27 635 / 34
Email: beat.walpoth@hcuge.ch
(Mrs. M. Kaeser, secretary)

TRAVEL INSURANCE

A personal travel insurance policy to cover theft, loss and medical problem is highly recommended. ESAO 2008 and MCI as organisers cannot accept to be held liable for any problem caused during the participant's travel and stay at the congress.

WEBSITE

www.esao2008.medecine.unige.ch



Registration Information

To make your reservation please use the online registration form available at:
www.esao2008.medecine.unige.ch

REGISTRATION FEES

ESAO 2008	Before 1 June 2008	After 1 June 2008	On site
ESAO Members and affiliated societies	EUR 350	EUR 400	EUR 450
Non-ESAO Member	EUR 400	EUR 450	EUR 500
ESAO Member from Eastern European Countries and from Low and Lower-Middle Income Countries*	EUR 250	EUR 300	EUR 350
Non-ESAO Members from Eastern European Countries and from Low and Lower-Middle Income Countries*	EUR 300	EUR 350	EUR 400
Students and PhD students (under 35 years of age) / Nurses**	EUR 150	EUR 200	EUR 250
Accompanying Persons	EUR 70	EUR 100	EUR 120
1-Day registration	EUR 200	EUR 250	EUR 250

* See list on next page

** For students, a letter of confirmation from the Head of Department or a student card is required as a proof of eligibility

Delegates' registration fee includes:

- Admission to all sessions
- Access to exhibition
- Congress delegate bag
- Final programme
- International Journal of Artificial Organs (with published abstracts)
- Opening Ceremony and Welcome Reception
- Scheduled coffee breaks
- Access to concert
- Certificate of attendance

Accompanying person's registration fee includes:

- Access to exhibition
- Scheduled coffee breaks
- Opening Ceremony and Welcome Reception
- Access to concert
- City Tour



SOCIAL EVENTS

Congress Dinner Delegates: EUR 60

Delegates from Eastern European Countries and from Low and Lower-Middle Income Countries: EUR 50

Students: EUR 40

City Tour

Delegates: EUR 30

Included in accompanying person registration fee

For further information please see page 23/24

*List of Eastern European Countries and Low and Lower-Middle Income Countries

Afghanistan	Guatemala	Pakistan
Albania	Guinea	Papua New Guinea
Algeria	Guinea-Bissau	Paraguay
Angola	Guyana	Peru
Armenia	Haiti	Philippines
Azerbaijan	Honduras	Poland
Bangladesh	India	Republic Sierra Leone
Belarus	Indonesia	Romania
Benin	Iran, Islamic Rep.	Russia
Bhutan	Iraq	Rwanda
Bolivia	Jamaica	Samoa
Bosnia and Herzegovina	Jordan	São Tomé and Príncipe
Bulgaria	Kazakhstan	Senegal
Burkina Faso	Kenya	Serbia
Burundi	Kiribati	Slovakia
Cambodia	Korea, Dem. Rep.	Slovenia
Cameroon	Kyrgyz	Solomon Islands
Cape Verde	Lao PDR	Somalia
Central African Republic	Latvia	Sri Lanka
Chad	Lesotho	Sudan
China	Liberia	Suriname
Colombia	Lithuania	Swaziland
Comoros	Macedonia, FYR	Syrian Arab Republic
Congo, Dem. Re	Madagascar	Tajikistan
Congo, Rep.	Malawi	Tanzania
Côte d'Ivoire	Maldives	Thailand
Croatia	Mali	Timor-Leste
Cuba	Marshall Islands	Togo
Czech Republic	Mauritania	Tonga
Djibouti	Micronesia, Fed. Sts.	Tunisia
Dominican Republic	Moldova	Turkmenistan
Ecuador	Mongolia	Uganda
Egypt, Arab Rep.	Montenegro	Ukraine
El Salvador	Morocco	Uzbekistan
Eritrea	Mozambique	Vanuatu
Ethiopia	Myanmar	Vietnam
Estonia	Namibia	West Bank and Gaza
Fiji	Nepal	Yemen, Rep.
Gambia, The	Nicaragua	Yugoslavia
Georgia	Niger	Zambia
Ghana	Nigeria	Zimbabwe



Methods of Payment

Payment of registration and social events may be made by:

- Credit card: EuroCard/MasterCard, Visa, American Express
- Bank transfer to the following account:
MCI Suisse SA – ESAO 2008
UBS SA - CP 2600
CH-1211 Geneva 2 - SWITZERLAND
Account N° 240-369.393.71L
Clearing 240
Swift UBSWCHZH12A
IBAN CH 18 0024 0 240 36 93 9371L
Mention: ESAO 2008 and participant's name
- Payment by personal cheques cannot be accepted
- All payments have to be made in Euro (EUR)

Cancellation Policy

All cancellations and changes must be sent to MCI Suisse SA in writing (fax, letter or e-mail).

Registration

Full payment of these items is requested when registering (by credit card or by bank transfer). No confirmation will be sent until MCI Suisse SA has received the payment. All cancellations and changes must be sent to MCI Suisse SA in writing (fax, letter or email).

For cancellations prior to 24 June 2008, fees will be refunded less EURO 70 (for administrative costs). After this date, no refund is possible.

A handling fee of EURO 30 per registration will be charged for any modification after 6 July 2008.

Congress Dinner & City Tour

Cancellations can be made free of charge until 3 August 2008. After this date, no refund is possible.

Hotel Information

The participants who wish to reserve a hotel room are kindly asked to contact the selected hotel directly.

A selection of hotels can be found below. These hotels have been informed about ESAO 2008. A list of low cost hotels is also provided on the Congress website: www.esao2008.medecine.unige.ch. You can also visit the following websites to get more information: www.yh-geneva.ch – www.cityhostel.ch. Due to the proximity to the meeting venue we propose the cité universitaire as a low cost accommodation where a contingent of rooms have been reserved for the congress: <http://www.asso-etud.unige.ch/cite-uni/en/hebergementguest.php>

GENEVA HOTELS

HOTELS	Walking distance	TPG distance	CAR distance	MAPS CMU =	INTERNET WEBSITE	PHONE NUMBER
5 *****						
DE LA PAIX	25 min	25 min	10 min	H – 3	www.hoteldelapaix.ch	+41 22 909 60 00
INTERCONTINENTAL	45 min	30 min	15 min	E – 2	www.intercontinental.com/geneva	+41 22 919 39 39
MANDARIN ORIENTAL	25 min	25 min	7 min	H – 4	www.mandarinoriental.com/geneva	+41 00 909 00 00
4 SUP ****						
BRISTOL	35 min	25 min	8 min	H – 4	www.bristol.ch	+41 22 716 57 00
EPSOM	35 min	25 min	10 min	G – 3	www.manotel.com/epsom	+41 22 544 66 66
ROYAL	30 min	25 min	10 min	G – 3	www.manotel.com/royal	+41 22 906 14 14
4 *****						
AUTEUIL	30 min	25 min	10 min	G – 3	www.manotel.com/auteuil	+41 22 544 22 22
TIFFANY	20 min	25 min	10 min	G – 6	www.hotel-tiffany.ch/	+41 22 708 16 16
LONGEMALLE	15 min	20 min	6 min	I – 5	www.longemalle.ch	+41 22 818 62 62
NOVOTEL GENEVE CENTRE	30 min	20 min	7 min	G – 3	http://www.novotel.com/novotel	+41 22 909 90 00
WARWICK	35 min	25 min	10 min	G – 3	www.warwickgeneva.com/	+41 22 716 80 00
3 SUP ***						
EDELWEISS	30 min	25 min	8 min	G – 3	www.manotel.com/edelweiss	+41 22 544 51 51
JADE	35 min	25 min	8 min	G – 3	www.manotel.com/jade	+41 22 544 38 38
KIPLING	30 min	25 min	8 min	G – 3	www.manotel.com/kipling	+41 22 544 40 40
STRASBOURG	30 min	25 min	8 min	G – 3	www.strasbourg-geneva.ch	+41 22 906 58 00
3 ***						
MONTANA	25 min	20 min	7 min	G – 3	www.hotel-montana-ge.ch	+41 22 732 08 40
SAVOY	30 min	25 min	8 min	G – 3	www.hotels-suisse.ch/savoy	+41 22 906 47 00
2 **						
BERNINA	30 min	20 min	6 min	G – 3	www.bernina-geneve.ch	+41 22 908 49 50
AT HOME	30 min	20 min	7 min	G – 3	www.hotel-at-home.ch/	+41 22 906 19 00

Location MAP



- ① Train station
- ② CMU - Congress Venue
- ③ Congress Dinner – WMO
- ④ Concert location
- ⑤ Cité Universitaire

Social Events & Excursions

OPENING CEREMONY AND WELCOME RECEPTION

Wednesday, 03 September 2008, 17:00-20:00

With the support of the City of Geneva.

The Welcome Reception will be held after the opening ceremony at the Centre Medicine Universitaire (CMU). All registered participants and registered accompanying persons are cordially invited.

CONCERT

Thursday, 04 September 2008, 19:00-20:00

The concert will take place at the Conservatoire de Genève. All registered participants and registered accompanying persons are cordially invited.

Address: Place Neuve – 1204 Geneva (see map)

How to get there:

The Conservatoire is in walking distance of the CMU (Approx. 10 minutes).

Tram 12, stop "Place Neuve", Tram 13-14-15-16 stop "Cirque". Buses 5 and 3 also stop at the "Place Neuve", which faces the Conservatoire.

CONGRESS DINNER

Friday, 05 September 2008, 19:00 – 23:00



The Congress Dinner will take place at the World Meteorological Organization (WMO), a United Nations Specialized Agency.

The UN system's authoritative voice on the state and behavior of the Earth's atmosphere, its interaction with the oceans, the climate it produces and the resulting distribution of water resources. The World Meteorological Organization is an intergovernmental organization with a membership of 187 Member States and Territories. It originated from the International Meteorological Organization (IMO), which was founded in 1873. Established in 1950, WMO became the specialized agency of the United Nations for meteorology (weather and climate), operational hydrology and related geophysical sciences. Since its establishment, WMO has played a unique and powerful role in contributing to the welfare of humanity. Under WMO leadership and within the framework of WMO programs, National Meteorological and Hydrological Services have contributed substantially to the protection of life and property against natural disasters, to safeguarding the environment and to enhancing the economic and social well-being of all sectors of society in areas such as food security, water resources and transport. It has a unique role within the UN system it facilitates the free and unrestricted exchange of data and information, products and services in real- or near-real time on matters relating to safety and security of society, economic well being and the prevention of the environment. As weather and climate know no national boundaries, international cooperation at a global scale is essential for the development of meteorology and operational hydrology as well



as to reap the benefits from their applications. WMO provides the framework for such international cooperation

The top Floor of the WMO building has been exclusively reserved for this Congress Dinner and offers a splendid view over the lake of Geneva and its surroundings.

Address: 7bis, Avenue de la Paix - 1202 Geneva - Switzerland – www.wmo.ch

How to get there:

From Cornavin Station: Buses 1, 11 and 28 stop at the “Jardin Botanique”, which faces the WMO building. Trams 13 and 15 go to the “Place des Nations”. The WMO is then within walking distance (Avenue de la Paix, towards the lake – 10 minutes).

Reservation for the Congress Dinner can be made via the official registration site. Applicable rates are: **EUR 60** (reduced rates: **EUR 50** for delegates from Eastern European Countries and from Low and Lower-Middle Income Countries, **EUR 40** for students).

CITY TOUR

Thursday, 4 September 2008, 14:00 – 17:00



Departure in front of the CMU.

Nobody should leave Geneva without seeing its monuments and historical sites. We will take you to the most important ones in three hours, including the symbol of the city, the famous “water jet”; this impressive 460ft (140m) high lake water fountain, the first of its kind, was completed in 1891.

The flower clock in the English garden is another symbol of Geneva, known all over the world. The monument of Duke of

Brunswick, who left his entire fortune to the City of Geneva, is located right on the opposite side of Lake Geneva.

The historical Old Town will be visited on foot to discover its carefully preserved charm. The Cathedral Saint-Pierre constructed in the 12th and 13th centuries dominates the Old Town. Right next to it is the Auditorium, where Jean Calvin taught. Calvin arrived in 1536 in Geneva.

Leading figure of the protestant Reformation, he deeply influenced religion, ethics and social life in the western world. The oldest privately constructed building is the Maison Tavel, now transformed into a museum of old Geneva.

With its parks and gardens, its monuments and museums, Geneva is today truly international and cosmopolitan, not only in population but also in its whole atmosphere.

Reservation for the City Tour can be made via the official registration site.

Applicable rates are: Complementary for fully registered accompanying persons, **EUR 30** for active participants.

FURTHER EXCURSIONS

Participants will be able to book further excursions directly through Key Tours onsite at the meeting venue or in advance at <http://www1.wwsa.ch/keytours>





ESAO 2008 – CONFIRMED SPONSORS & EXHIBITORS

ESAO would like to thank the following Sponsors & Exhibitors
(confirmed at 15 February 2008)

ATS Medical



Baxter



Berlin Heart



Bioring



BioAlps



Biotronik



Euromed



Fresenius
Medical Care



Heartware



Nisco Engineering



Medi-Stim



MCMmedsys



Mussler Medical Supply MMS



St. Jude Medical



Wichtig



ESAO 2008 - CORPORATE MEMBERS

The European Society for Artificial Organs is generously
supported by its Corporate members

Amgen



Genzyme



Baxter



Nipro



Fresenius
Medical Care



Organ Assist



Gambro



Saxonia



Important Dates to bookmark

Pre-registration:
Open

Opening Abstract Submission:
15 February 2008

Deadline Abstract Submission:
1 April 2008

Notification of Abstract
Submission:
15 May 2008

Registration early fee
15 June 2008



Faculty of Medicine
Faculty of Sciences

UNIVERSITÉ DE GENÈVE

Unil

UNIL | Université de Lausanne



ÉCOLE POLYTECHNIQUE
FÉDÉRALE DE LAUSANNE

HUG  
Hôpitaux Universitaires de Genève

